

Sale Name: Saline County IL 412.6+- Acres / 8 Tracts / Farmland Pasture Ponds / 2976A

LOT 3 - TRACT 3

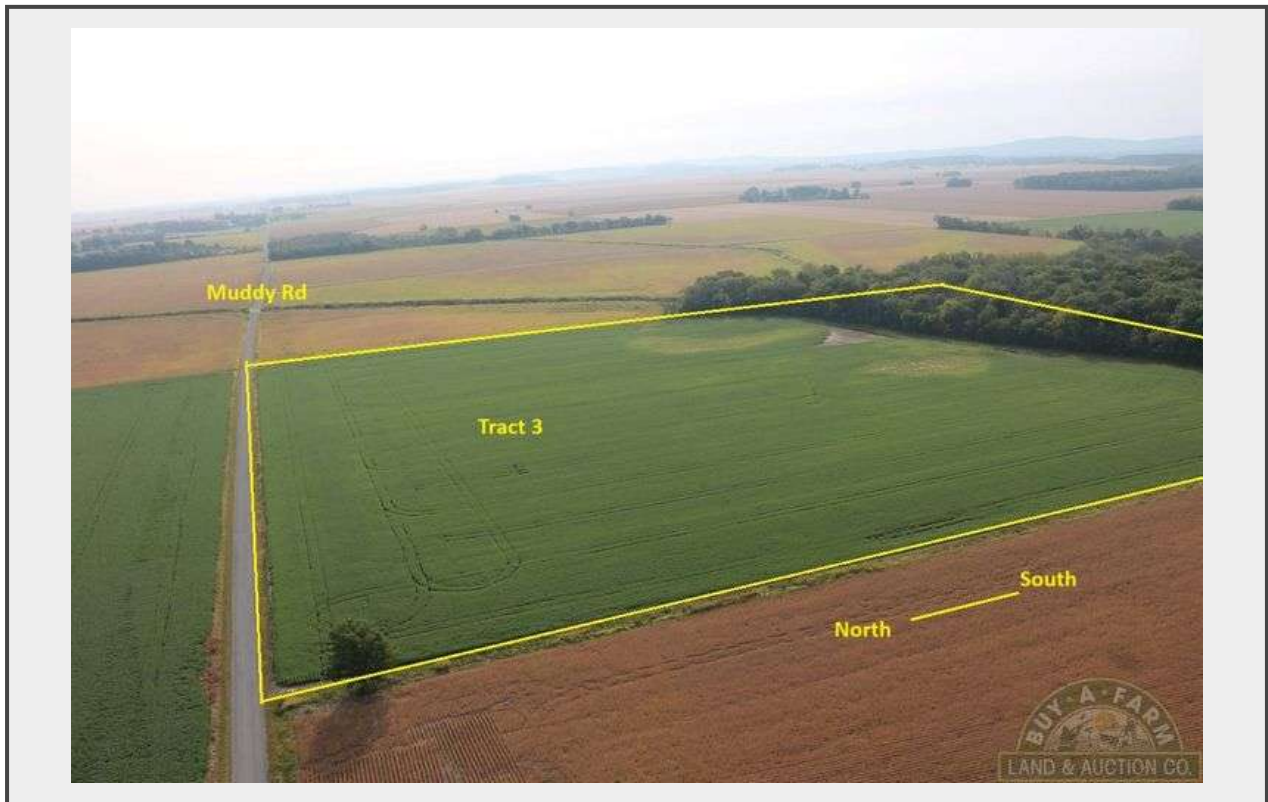

Description

Tract 3: 40+/- Acres (tax acres)

- Lays flat to gently sloping
- 36.6 tillable FSA acres
- 109.5 soil PI
- Road frontage at 1075 North Muddy Road

Quantity: 1



<https://www.buyafarm.land/>